

6100 Series AC Hysteresis Motors

- ☞ Larger external rear output bearing
- ☞ Designed with stall torque performance
- ☞ Ultra smooth, ultra quiet operation
- ☞ Rotation direction: CW and CCW
- ☞ Lifetime lubrication
- ☞ UL Approved, Class F Rating



Model 6100
with optional shafts

Applications:



Transit Ticket
Dispensers



Point-Of-Purchase
Displays



HVAC Actuators
& Dampers



ATM's

6100 Series AC Hysteresis Motors

Description

M.H. Rhodes/Cramer Company AC Hysteresis Motor are synchronous-type motors that provides smooth, quiet performance and allows operation to a stall condition without damage or increase in temperature. External rear bearing provides stability, strength and allows for a double-ended output shaft that can be configured with pinions, levers, flats or knurls. The pear shaped gearbox is designed to contain a wide range of gear ratios to meet your specific requirements.

Dimensions



Model 6100

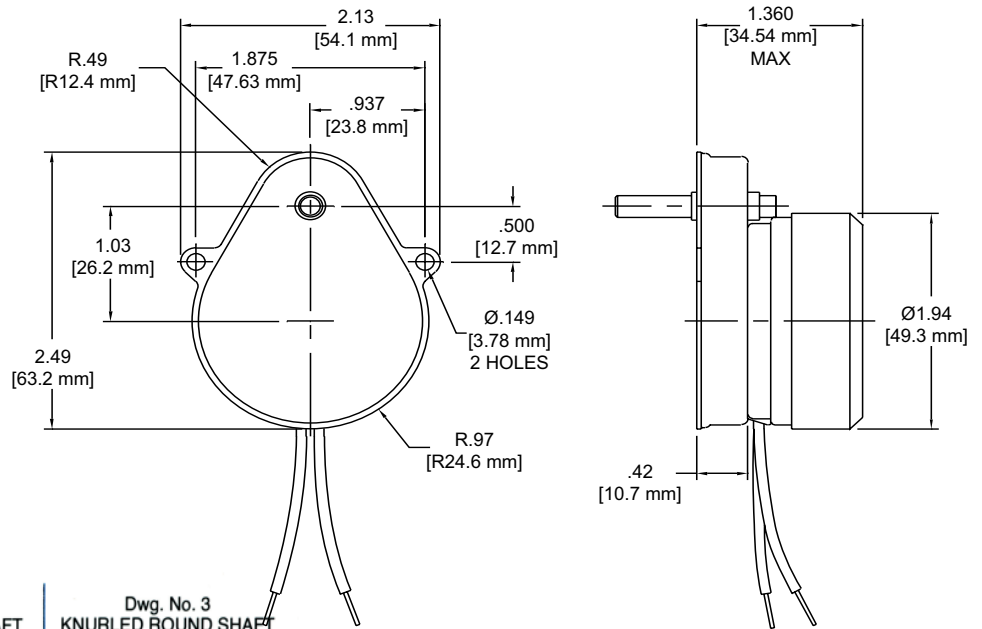

Shaft Information

Dwg. No. 1
ROUND SHAFT

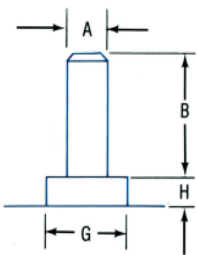

Dwg. No. 2
FLATTED ROUND SHAFT

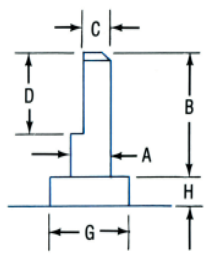

Dwg. No. 3
KNURLED ROUND SHAFT

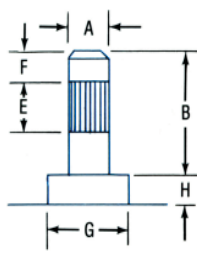

To better assist you in selecting a motor that meets your specifications, please provide the following information:



- Shaft type (round, flat or knurled)
- Shaft diameter (A)
- Shaft length (B)
- Shaft width at flat (C)
- Shaft length at flat (D)
- Knurl length (E)
- Knurl set back (F)
- Bearing OD (G)
- Bearing height (H)

For additional shaft and motor specification information, please visit www.mhrhodes-cramer.com "Shaft Information" page.

Specifications

Model	5 Watt	6 Watt
Starting Torque @ 1 RPM	60 oz. in.	60 oz. in.
Running Torque @ 1 RPM	60 oz. in.	60 oz. in.
Operating Temperature Range	-40°F to 212°F (-40°C to 100°C)	
Insulation Class	UL Class F Rating (155°C)	
Voltage Offered	24, 120 and 240 (50 & 60 Hz) VAC	
Standard Speeds	1, 2, 4, 5, & 6 RPM	
Direction of Rotation	CW & CCW	
Agency Approval	UL	

Options

-  Extended shafts for manual rotation of motor or actuator
-  Double-ended shafts for actuation of two devices

www.mhrhodes-cramer.com



M.H. Rhodes/Cramer Company
105 Nutmeg Road South • South Windsor, CT 06074 USA
Toll Free: 877.684.6464 • PH: 860.291.8402 • FX: 860.620.0897