

# 800 Series DC Permanent Magnet Motors

- ☞ Larger external rear output bearing for fast starts & stops
- ☞ Designed with stall torque performance
- ☞ Quiet operation
- ☞ Rotation direction: CW and CCW
- ☞ Lifetime lubrication
- ☞ UL Approved, Class F Rating



Model 800HN



Model 800P

## Applications:



Automatic Teller  
Machings



Marine  
Navigation Aids



Transit Ticket  
Dispensers



Aircraft Lighting

# 800 Series DC Permanent Magnet Motors

## Description

M.H. Rhodes/Cramer Company DC Permanent Magnet Motors are a shaded pole, synchronous-type that provides smooth, quiet performance and allows operation to a stall condition without damage or increase in temperature rise. External rear bearing provides stability, strength and allows for a double-ended output shaft that can be configured with pinions, levers, flats or knurls. DC permanent magnet motors are available with a pear-shaped gearbox designed to contain a wide range of gear ratios.

## Dimensions



Model 800HN



Model 800P

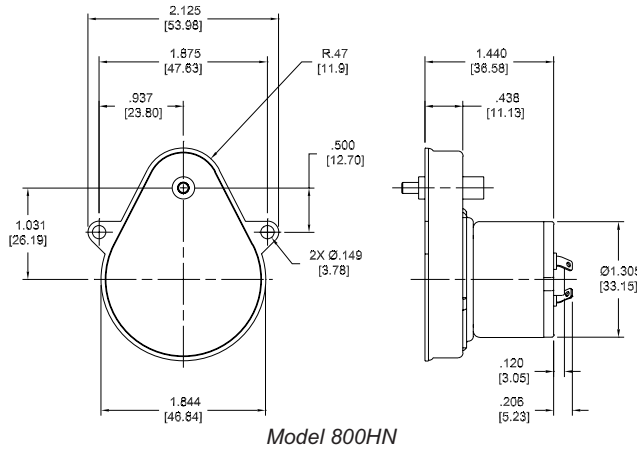

Model 800HN

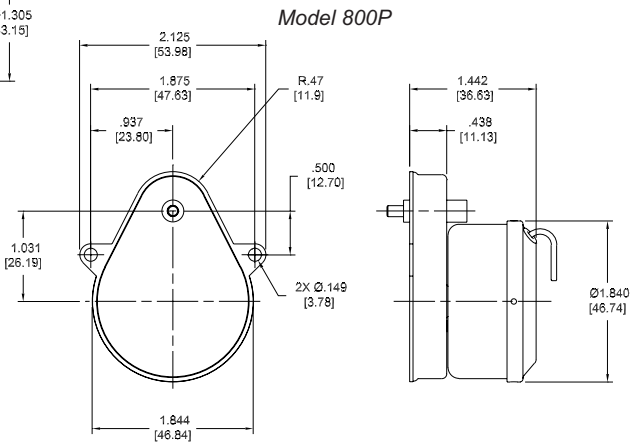

Model 800P

## Shaft Information

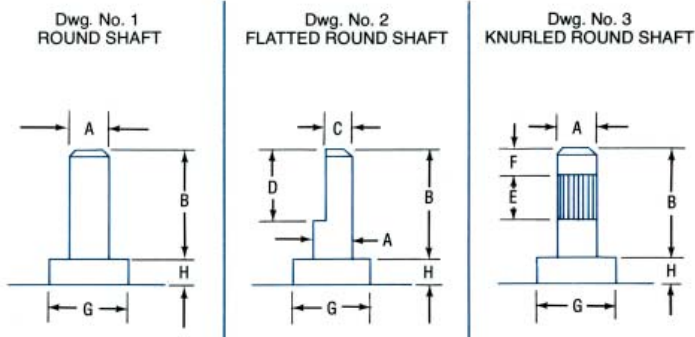

To better assist you in selecting a motor that meets your specifications, please provide the following information:

- Shaft type (round, flat or knurled)
- Shaft diameter (A)
- Shaft length (B)
- Shaft width at flat (C)
- Shaft length at flat (D)
- Knurl length (E)
- Knurl set back (F)
- Bearing OD (G)
- Bearing height (H)

For additional shaft and motor specification information, please visit [www.mhrhodes-cramer.com](http://www.mhrhodes-cramer.com) "Shaft Information" page.

## Specifications

Model	800P and 800HN
Starting Torque @ 1 RPM	60 oz. in.
Running Torque @ 1 RPM	60 oz. in.
Current Input (No load)	as low as 18 ma.
Standard Voltage	4 to 24 VDC
Operating Temperature Range	+77°F to 185°F (+25°C to 85°C)
Gear Train Rating	Standard Duty
Static	90 oz. in.
Dynamic	30 oz. in.
Noise Suppression	Varistor type
Mounting Centers (Round)	2.125 in. (53.975 mm)
Mounting Centers (Pear)	1.875 in. (47.625 mm)
Standard Mounting	2 hole
Agency Approval	UL, RoHS Compliant

## Options

- Extended shafts for manual rotation of motor or actuator
- Double-ended shafts for actuation of two devices

[www.mhrhodes-cramer.com](http://www.mhrhodes-cramer.com)



M.H. Rhodes/Cramer Company  
 105 Nutmeg Road South • South Windsor, CT 06074 USA  
 Toll Free: 877.684.6464 • PH: 860.291.8402 • FX: 860.620.0897